

S. NO.	AEL PART NO.	PART DESCRIPTION	NO. OF LOBES	SPECIFICATIONS	ECCENTRICITY	APPLICATION	CALCULATED DISPLACEMENT	DISPLACEMENT AT 1500 RPM & AT WORKING PRESSURE OF 5 BARS	
1	PMP/663	Inner Rotor (03 Lobes) with Keyway	3/4 Lobe	Flat to Tip	25.08mm	2.794mm	Oil Pumps for Perkins Engines in Massey Ferguson Tractors	0.406 cc/rev/mm OR 14.20 cc/rev	21.55 Liters/min.
	PMP/664	Outer Rotor		Inner Diameter	12.65mm				
				Height	35.40mm				
				Outer Diameter	42.00mm				
2	PMP/362	Inner Rotor (04 Lobes)	4/5 Lobe	Form Diameter	25.19mm	2.800mm	Oil Pumps for Perkins Engines in Massey Ferguson Tractor Model # 135	0.416 cc/rev/mm OR 7.91 cc/rev	11.90 Liters /min
	PMP/149	Outer Rotor		Height (Max.)	35.40mm				
				Tip Diameter	29.67 mm				
				Inner Diameter	12.67 mm				
3	PMP/611	Inner Rotor (04 Lobes)	4/5 Lobe	Height	19.00 mm	3.505mm	Oil Pumps for Sports Cars	0.575 cc/rev/mm OR 20.41 cc/rev	30.62 Liters/min.
	PMP/612	Outer Rotor		Outer Diameter	40.90mm				
				Form Diameter	24.20mm				
				Height	19.00mm				
4	PMP/141	Inner Rotor (04 Lobes)	4/5 Lobe	Tip Diameter	35.00mm	3.800mm	Oil Pump for Industrial Applications	0.794 cc/rev/mm OR 7.65 cc/rev.	11.40 Liters/min.
	PMP/143	Inner Rotor (04 Lobes) with 'D' Type ID		Inner Diameter	12.70mm				
				Height	35.50mm				
				Outer Diameter	49.10mm				
	PMP/142	Outer Rotor		Form Diameter	28.10mm				
				Height	35.50mm				
Tip Diameter			41.74 mm						
5	PMP/559	Inner Rotor (04 Lobes)	4/5 Lobe	Inner Diameter	16.00 mm	4.000mm	Oil Pumps for Ford Transit vans	0.867 cc/rev/mm OR 29.40 cc/rev.	44.00 Liters/min.
	PMP/560	Outer Rotor		Height	09.64 mm				
				Tip Diameter	41.74 mm				
				Inner Diameter	15.86 mm				
	PMP/560	Outer Rotor		Height	09.64 mm				
				Outer Diameter	58.00 mm				
Form Diameter			34.24 mm						
PMP/560	Outer Rotor	Height	09.64 mm						
		Outer Diameter	61.03mm						
		Form Diameter	35.40mm						
PMP/560	Outer Rotor	Height	34.00mm						
		Outer Diameter	61.03mm						
		Form Diameter	35.40mm						
PMP/560	Outer Rotor	Height	34.00mm						
		Outer Diameter	61.03mm						
		Form Diameter	35.40mm						

S. NO.	AEL PART NO.	PART DESCRIPTION	NO. OF LOBES	SPECIFICATIONS		ECCENTRICITY	APPLICATION	CALCULATED DISPLACEMENT	DISPLACEMENT AT 1500 RPM & AT WORKING PRESSURE OF 5 BARS
6	PMP/784	Inner Rotor (04 Lobes) with Key Way	4/5 Lobe	Tip Diameter	48.22mm	4.775mm	Oil Pump for Industrial Applications	1.148 cc/rev/mm OR 14.58cc/rev.	43.74 Liters/min
	PMP/785	Outer Rotor		Inner Diameter	14.325mm				
7	PMP/582	Inner Rotor (06 Lobes) with Spline ID	6/7 Lobe	Height	25.4mm	3.560mm	Oil Pumps for Perkins Engines in Massey Ferguson Tractor Model #'s 375 & 385	1.06 cc/rev/mm OR 23.06 cc/rev	34.60 Liters/min.
	PMP/583	Outer Rotor		Outer Diameter	66.713 mm				
8	PMP/674	Inner Rotor (06 Lobes)	6/7 Lobe	Form Diameter	38.80mm	3.560mm	Oil Pump for Ford Tractor Model 6610-7000 Series	1.06 cc/rev/mm OR 47.38 cc/rev	71.00 Liters/min.
	PMP/675	Outer Rotor		Height	25.4mm				
9	PMP/651	Inner Rotor (07 Lobes) with 'D' Shape Id	7/8 Lobe	Tip Diameter	54.63mm	1.065mm	Oil Pump for Honda Motorcycles 125cc engines	0.104 cc/rev/mm OR 1.24 cc/rev	1.87 Liters/min.
	PMP/652	Outer Rotor		Inner Diameter	24.68mm				
10	PMP/458	Inner Rotor (Eight Lobe)	8/9 Lobe	Height	21.75mm	0.844mm	Oil Pumps for Automotive Applications	0.085 cc/rev/mm OR 0.585 cc/rev.	0.88 Liters/min
	PMP/459	Outer Rotor		Outer Diameter	69.65mm				
11	PMP/685	Inner Rotor (08 Lobes) With Square & Half-Moon Key Way	8/9 Lobe	Form Diameter	47.63mm	1.326mm	Oil Pumps for Automotive Applications	0.203 cc/rev/mm OR 1.29 cc/rev.	1.93 Liters/min
	PMP/686	Outer Rotor		Height	21.75mm				

S. NO.	AEL PART NO.	PART DESCRIPTION	NO. OF LOBES	SPECIFICATIONS	ECCENTRICITY	APPLICATION	CALCULATED DISPLACEMENT	DISPLACEMENT AT 1500 RPM & AT WORKING PRESSURE OF 5 BARS	
12	PMP/814	Inner Rotor (10 Lobes)	10/11 Lobe	Tip Diameter	60.40mm	2.500mm	Oil Pumps for Suzuki16100-82605	0.876 cc/rev/mm OR 7.87cc/rev.	10.51 Litres /min
				Inner Diameter	38.1mm				
				Height	8.00mm				
	Outer Diameter	73.9 mm							
	Form Diameter	55.5mm							
	Height	8.00mm							
PMP/815	Outer Rotor								

NOMENCLATURE OF GEROTORS (OIL PUMP)

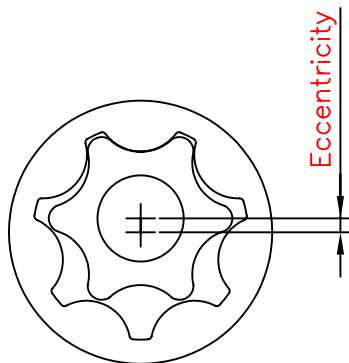
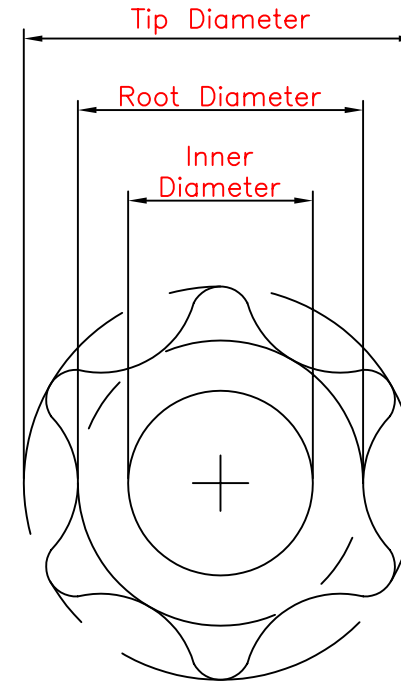
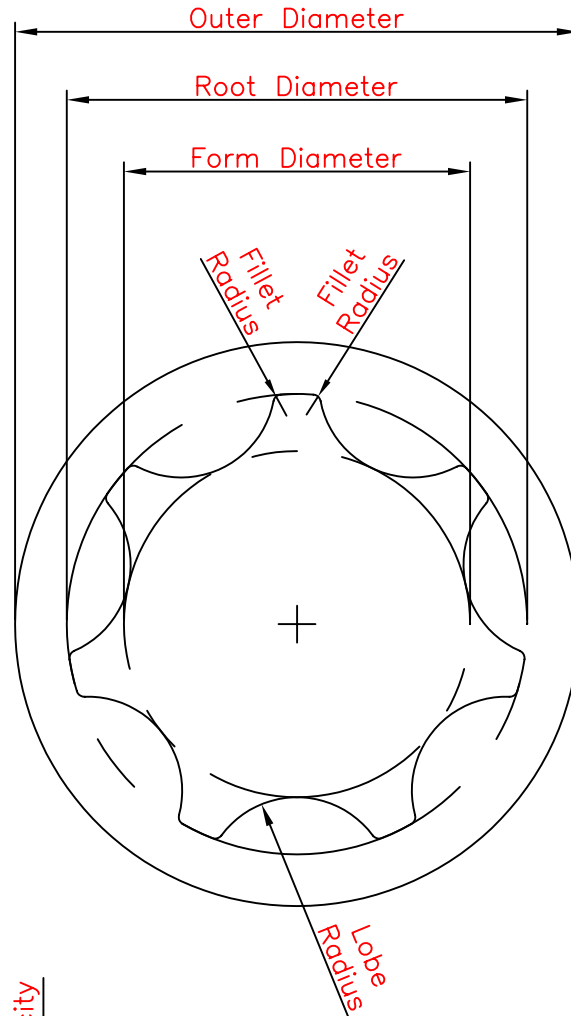

Tolerance symbols forms & positions			Units	Replacement for	Drawn by	Checked by	Approved by	Projection
Straightness —	Surface	Perpendicularity \perp			I.A.Qazi			
Flatness ▮	Profile	Concentricity ◎			Date	Date	Date	
Roundness ○	Parallelism //	Symmetry ≡	Scale	Material				
Cylindricity ○	Position ⊕	Circular Runout ⌒	NTS		24-12-14			
Line Profile ⌒	Angularity ∠	Total Runout ⌒						
Application No.	Pos. Index	Alteration			DCR No.	Date	Approved	
		Denomination:			Drawing No.		Index	
		6/7 Lobe Rotor Set Nomenclature			C10 113			